

CaprizPlus
high efficiency
combi range

**Key features
and benefits:
24kW
28kW**



Introducing . . .

CaprizPlus

The Heatline CaprizPlus high efficiency condensing combination boiler is available in 24kW and 28kW outputs and is fitted with a 24 hour easy-to-use analogue timer. Delivered with a 1 year manufacturer's parts and labour warranty, the CaprizPlus meets modern Part L Building Regulations 2010.

The CaprizPlus achieves SEDBUK 2009 efficiency ratings of 88.9% (24kW) and 88.8% (28kW) – the equivalent of a SEDBUK 2005 A rating.

Our lightweight easy-to-install boiler is an excellent choice for those requiring a no-nonsense, value for money combi solution.

Key Features

- Compact and lightweight for easy installation
- Factory fitted analogue timer
- Large surface area composite heat exchanger to maximise heat transfer
- User friendly controls – digital diagnostic display
- In-built frost protection
- DHW flow rate:
 - 9.4 l/m at ΔT 35°C (24kW)
 - 11.4 l/min at ΔT 35°C (28kW)
- 1 year parts and labour warranty

Easy Installation

- Compact size:
 - 740mm (H) x 425mm (W) x 310mm (D) (24kW)
 - 740mm (H) x 425mm (W) x 340mm (D) (28kW)
- Lightweight:
 - 32.5kg (24kW)
 - 34kg (28kW)
- Analogue pressure gauge simplifies commissioning
- Push fit flue system
- Easy wiring



CaprizPlus Specification

Performance	1006642190	1006646190
Model Performance	24kW	28kW
CH output (kW) Min/Max	7.8 – 18kW	9.2 – 24kW
DHW output (kW) Min/Max	8 – 24kW	9.5 – 28kW
DHW flow rate (l/min, 35°C rise)	9.4 l/min	11.4 l/min
LPG compatible	yes	yes
SEDBUK 2009 rating	88.9%	88.8%
Summer efficiency	79.7%	79.6%
Winter efficiency	89.8%	89.8%
Technical		
Main heat exchanger type	composite 4 coil	composite 5 coil
Heat exchanger material	stainless steel	stainless steel
Burner type	pre-mix	pre-mix
Fully modulating	yes	yes
DHW plate heat-exchanger	yes	yes
Integrated hydroblock	yes	yes
Sealed system	yes	yes
Size (HxWxD) mm	740 x 425 x 310	740 x 425 x 340
Lift weight	32.5kg	34kg
Total weight	37kg	38.2kg
Maximum flue lengths		
Horizontal	6 metres	6 metres
Vertical	6 metres	6 metres
Anti plume	Yes	Yes

Standard flue kit

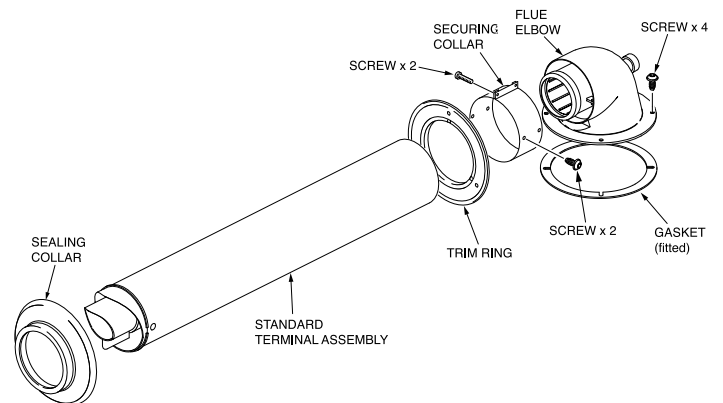

CaprizPlus comes with a standard flue kit and additional flueing options to meet any potential requirement. See diagrams and tables opposite to calculate your configuration.

A full range of accessories is also available (see flue accessories table).

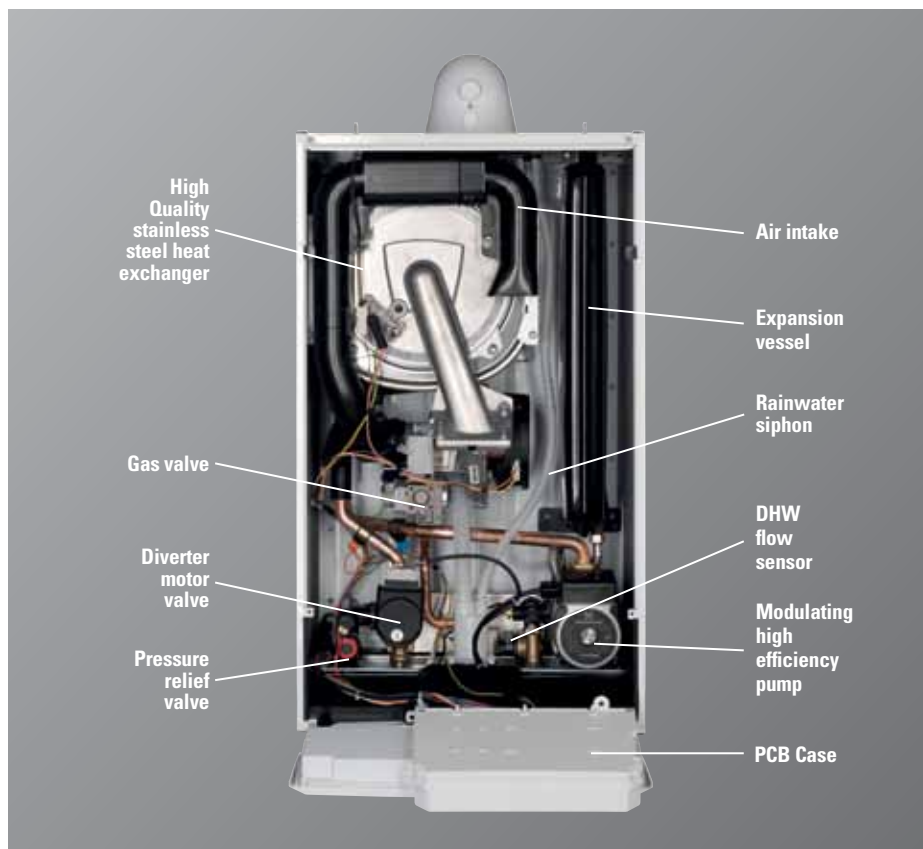

Horizontal flueing options

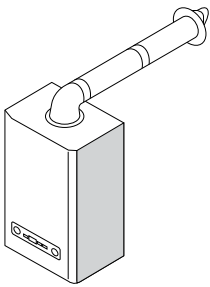

Flue options							Article No
Flue length (m)	0.6	1.6	2.6	3.6	4.6	5.6	
Standard flue kit	1	1	1	1	1	1	0020118012
2m Extension			1	1	2	2	0020118013
1m Extension		1		1		1	0020118014
90° Elbow							0020118015
2x45° Elbow							0020118016
Anti Plume Kit	Optional	Optional	Optional	Optional	Optional	Optional	0020118018
Terminal deflector kit	Optional	Optional	Optional	Optional	Optional	Optional	0020123786
Flue support clips (x3)		1	1	1	1	2	0020118017

The maximum physical flue length in this configuration cannot exceed 6 metres.

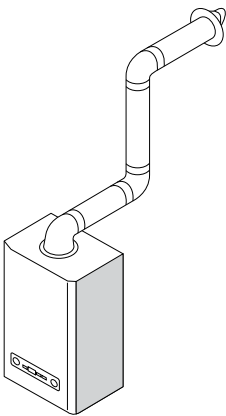

Flue options			Article No
Flue length (m)	2.6	3.6	
Standard flue kit	1	1	0020118012
2m Extension		1	0020118013
1m Extension	2	1	0020118014
90° Elbow	2	2	0020118015
2x45° Elbow			0020118016
Anti Plume Kit	Optional	Optional	0020118018
Terminal deflector kit	Optional	Optional	0020123786
Flue support clips (x3)	1	1	0020118017

The maximum physical flue length in this configuration cannot exceed 4 metres.

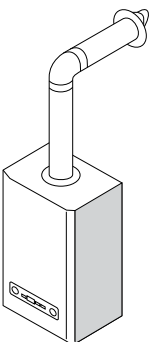

Flue options					Article No
Flue length (m)	1.6	2.6	3.6	4.6	
Standard flue kit	1	1	1	1	0020118012
2m Extension		1	1	2	0020118013
1m Extension	1		1		0020118014
90° Elbow	1	1	1	1	0020118015
2x45° Elbow					0020118016
Flue adaptor	1	1	1	1	0020118019
Anti Plume Kit	Optional	Optional	Optional	Optional	0020118018
Terminal deflector kit	Optional	Optional	Optional	Optional	0020123786
Flue support clips (x3)	1	1	1	1	0020118017

The maximum physical flue length in this configuration cannot exceed 5 metres.

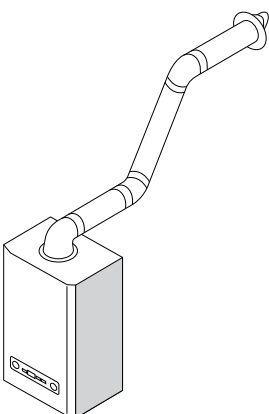

Flue options					Article No
Flue length (m)	2.6	3.6	4.6	4.6	
Standard flue kit	1	1	1	1	0020118012
2m Extension		1	1	2	0020118013
1m Extension	2	1	2		0020118014
90° Elbow					0020118015
2x45° Elbow	1	1	1	1	0020118016
Anti Plume Kit	Optional	Optional	Optional	Optional	0020118018
Terminal deflector kit	Optional	Optional	Optional	Optional	0020123786
Flue support clips (x3)	1	1	2	2	0020118017

The maximum physical flue length in this configuration cannot exceed 5 metres.

Vertical flueing options

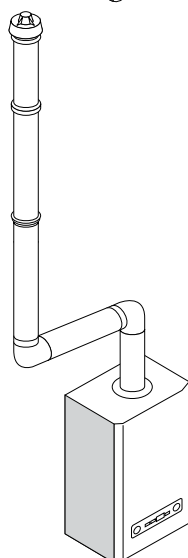
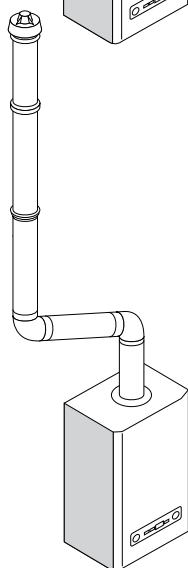
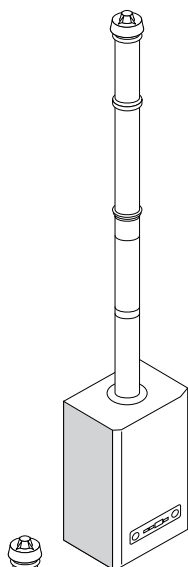

Flue options						Article No
Flue length (m)	1.5	2.5	3.5	4.5	5.5	
2m Extension			1	1	2	0020118013
1m Extension		1		1		0020118014
Anti Plume Kit	N/A	N/A	N/A	N/A	N/A	0020118018
Vertical Flue adaptor	1	1	1	1	1	0020118019
Sliding Sleeve	Optional	Optional	Optional	Optional	Optional	0020118020
Flexible pitch Roof Seal	Optional	Optional	Optional	Optional	Optional	0020118021
Flat Roof penetration collar	Optional	Optional	Optional	Optional	Optional	0020118022
Vertical Terminal	1	1	1	1	1	0020118023
Terminal deflector kit	N/A	N/A	N/A	N/A	N/A	0020123786
Flue support clips (x3)		1	1	1	1	0020118017

The maximum physical flue length in this configuration cannot exceed 6 metres.

Flue options				Article No
Flue length (m)	3.5	4.5	4.5	
2m Extension		1		0020118013
1m Extension	2	1	3	0020118014
90° Elbow				0020118015
2x45° Elbow	1	1	1	0020118016
Anti Plume Kit	N/A	N/A	N/A	0020118018
Vertical Flue adaptor	1	1	1	0020118019
Sliding Sleeve	Optional	Optional	Optional	0020118020
Flexible pitch Roof Seal	Optional	Optional	Optional	0020118021
Flat Roof penetration collar	Optional	Optional	Optional	0020118022
Vertical Terminal	1	1	1	0020118023
Terminal deflector kit	N/A	N/A	N/A	0020123786
Flue support clips (x3)	1	1	2	0020118017

The maximum physical flue length in this configuration cannot exceed 5 metres.

Flue options			Article No
Flue length (m)	2.6		
2m Extension			0020118013
1m Extension	2		0020118014
90° Elbow	2		0020118015
2x45° Elbow			0020118016
Anti Plume Kit	Optional		0020118018
Vertical Flue adaptor	1		0020118019
Sliding Sleeve	Optional		0020118020
Flexible pitch Roof Seal			0020118021
Flat Roof penetration collar			0020118022
Vertical Terminal	1		0020118023
Terminal deflector kit	Optional		0020123786
Flue support clips (x3)	1		0020118017

The maximum physical flue length in this configuration cannot exceed 3 metres.

Flue accessories

	Item	Article No
	2m Extension	0020118013
	1m Extension	0020118014
	90° Elbow	0020118015
	2x45° Elbow	0020118016
	Anti Plume Kit	0020118018
	Vertical Flue adaptor	0020118019
	Sliding Sleeve	0020118020
	Flexible pitch Roof Seal	0020118021
	Flat Roof penetration collar	0020118022
	Vertical Terminal	0020118023
	Terminal deflector kit	0020123786
	Flue support clips (x3)	0020118017

When calculating the flue length required, please allow for the following:
 Adding a 90° elbow reduces total flue length by 1 metre,
 Adding 2 x 45° elbows reduces total flue length by 1 metre.
 Due to constant improvements on products we reserve the right to alter specifications at any time without prior notice.



Heatline
Nottingham Road,
Belper,
Derbyshire,
DE56 1JT

Tel: 01773 596 099
Fax: 01773 828 123
Email: sales@heatline.co.uk